

Conduit parts

RoHS

T joint



For vinyl pipe

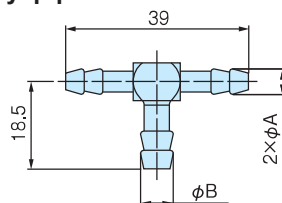

Item number	A (mm)	B (mm)	Material
TVT6-6-6	7	7	Brass
TVT6-4-6	7	5,5	
TVT4-6-4	5,5	7	
TVT4-4-4	5,5	5,5	

For metallic pipe

Noncompliant with RoHS

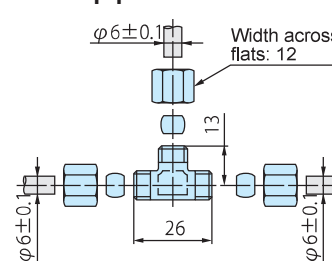

Item number	Material
TMT6-6-6	Brass

Elbow joint



For vinyl pipe

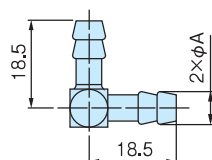

Item number	A (mm)	Material
LVT6-6	7	Brass
LVT4-4	5,5	

For metallic pipe

Noncompliant with RoHS

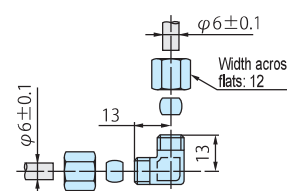

Item number	Material
LMT6-6	Brass

Straight joint



For vinyl pipe

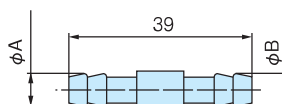

Item number	A (mm)	B (mm)	Material
SVT6-6	7	7	Brass
SVT4-4	5,5	5,5	
SVT6-4	7	5,5	

For metallic pipe

Noncompliant with RoHS

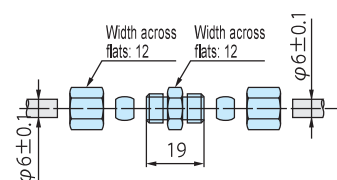

Item number	Material
SMT6-6	Brass

Panel penetration joint



For vinyl pipe

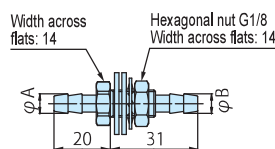

Maximum applicable panel thickness: 6 mm

Item number	A (mm)	B (mm)	Material	Panel cutting
PVT6-6	7	7	Brass/steel	φ10,5
PVT4-4	5,5	5,5	Brass/steel	
PVT6-4	7	5,5	Brass/steel	

For metallic pipe

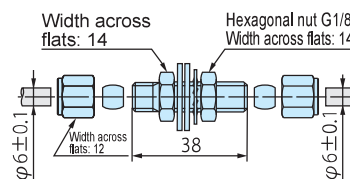

Maximum applicable panel thickness: 6 mm

Item number	Material	Panel cutting
PMT6-6	Brass/steel	φ10,5

For metallic/vinyl pipe

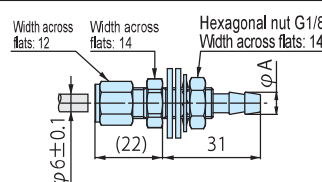

Maximum applicable panel thickness: 6 mm

Item number	A (mm)	Material	Panel cutting
PMVT6-6	7	Brass/steel	φ10,5
PMVT6-4	5,5	Brass/steel	

Warranty

■ Warranty period

The warranty period for our product is one (1) year from delivery to the location specified by the orderer who makes a direct transaction with us.

■ Scope of warranty

If any failure or defect attributable to us becomes clear during the above warranty period, we will repair the product or supply a substitute product free of charge. However, even during the warranty period, we will exclude the product from the scope of the warranty if the failure or defect corresponds to any of the following:

- (1) The failure or defect was caused by an unreasonable condition, environment, handling, or usage not mentioned in the instruction manual, specifications, and our product catalog.
- (2) The failure or defect was caused by a factor other than our product.
- (3) The failure or defect was caused by a modification or repair conducted by a party other than us.
- (4) The failure or defect was caused by an event that could not be foreseen at the scientific and technical levels at the time of product shipment from us.
- (5) The failure or defect was caused by an external factor not attributable to us, such as acts of God and disasters.

Please note that the warranty mentioned here means the warranty for our individual product, and damage provoked by a failure or defect of the product is excluded from the scope of the warranty.

*This warranty is valid only in Japan.

Application and usage

Our products are designed and manufactured as general-purpose instruments for general industries.

Therefore, our products are not intended for the following uses, and our products used in such a manner are outside the scope of application.

- (1) Equipment that is anticipated to greatly affect lives and properties, such as nuclear power generation, aviation, railways, marine vessels, vehicles, and medical devices
- (2) Utilities that include electricity, gas, and service water
- (3) Use in outdoor locations and under similar conditions or environments other than those stipulated in the instruction manual
- (4) Usage to which considerable safety consideration and attention equivalent to (1) and (2) above need to be given

Service

■ Scope of service

Because the product price does not include service expenses, such as the dispatch of engineers, we will separately charge for the expenses in the following cases:

- (1) Instruction for installation and adjustment and a witnessed test run
- (2) Maintenance inspection, adjustments, and repairs
- (3) Technical guidance and technical education
- (4) Witnessed inspections of products at our factory

<<Note>> The product specifications and information in this catalog are subject to change without prior notice for product improvement or other reasons.

● For order placement, contact

General
agent



Manostar Co., Ltd.

1-2-3 Nishishiriike-cho, Nagata-ku, Kobe City, Hyogo 653-0031
TEL. +81-78-621-7000 FAX. +81-78-621-7788

Manufacturer



Yamamoto Electric Works Co., Ltd.

1-2-3 Nishishiriike-cho, Nagata-ku, Kobe City, Hyogo 653-0031
TEL. +81-78-631-6000 FAX. +81-78-631-6020